

# CHECKPOINT EDGE™ NERVE CUTTING KIT

## PRESERVED SIDE

Larger aperture.  
Maintains circumferential support of the nerve.

## SACRIFICIAL SIDE

Indicated with caution lines. Smaller aperture. Holds the sacrificial nerve zone.

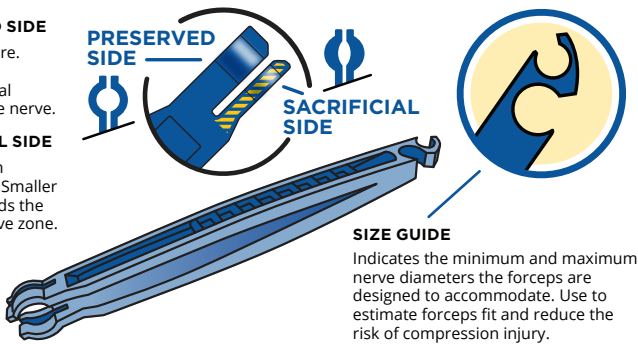

## SIZE GUIDE

Indicates the minimum and maximum nerve diameters the forceps are designed to accommodate. Use to estimate forceps fit and reduce the risk of compression injury.

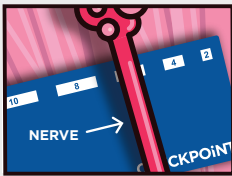

## 1. SIZE nerve.

Estimate nerve diameter and protect soft tissue with background.

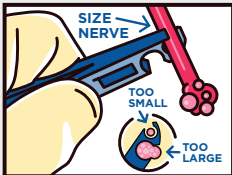

## 2. SELECT SM, MD or LG forceps.

Confirm forceps selection with proximal end size guide. Upsize or downsize as necessary.

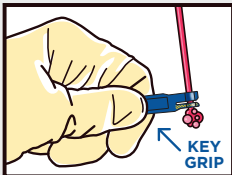

## 3. CONFIRM orientation. GRIP nerve.

Just prior to cutting, position the forceps with the **yellow striping near the nerve section being sacrificed. DO NOT release and re-grip.**

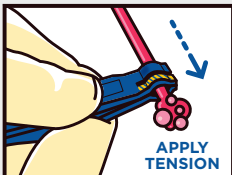

## 4. TENSION slightly.

Holding the nerve with the forceps, apply slight tension as shown.

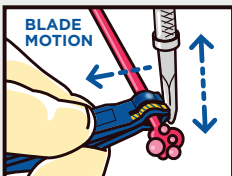

## 5. CUT squarely.

Insert the blade into the cutting slot. Use an oscillating movement to transect the nerve. Cut is perpendicular to the longitudinal axis of the nerve.

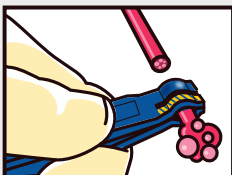

## 6. PRESERVED nerve releases from the forceps.

Nerve edge malformation is prevented. A reliable preparation results for aligned coaptation.



See instructions for use at [checkpointsurgical.com/ifu](http://checkpointsurgical.com/ifu) for complete listing of indications, contraindications, warnings, and precautions.

**Note:** Forceps may be used multiple times within the same surgery to produce prepared nerves. Properly dispose of all instruments after surgery.



### INDICATION FOR USE

Transecting nerve tissue for nerve graft preparation, nerve repair, or removal of exposed nerves.

### CHECKPOINT EDGE NERVE CUTTING KIT CONTENTS (ITEM #9250, EACH KIT)

QTY	DESCRIPTION
1	SM gray nerve forceps, 1-3 mm diameter
1	MD blue nerve forceps, 3-5 mm diameter
1	LG green nerve forceps, 5-7 mm diameter
1	Nerve microsurgical background
1	10R scalpel blade
1	SM69 scalpel blade

Scalpel handles sold separately.

### ADDITIONAL KIT SPECIFICATIONS

<b>Forceps</b>	Thermoplastic, contains barium-sulfate
<b>Sacrificial nerve resection width</b>	2 mm (indicated by yellow caution stripes)
<b>Forceps blade compatibility</b>	Accepts off-the-shelf scalpel blades ≤ 1 mm
<b>Microsurgical background</b>	25 × 50 mm, silicone, contains barium-sulfate
<b>Storage temp</b>	-30°C to +60°C

### RECOMMENDED HANDLES AND ORDERING INFORMATION

Recommended handle for SM69	Micro Surgical Handle
Recommended handle for 10R	No. 3 Surgical Handle
V0001 SM69 Fine Surgical Blade, box of 25*	V0003 Micro Surgical Handle, qty 1*
V0002 10R Surgical Blade, box of 100*	V0004 No. 3 Surgical Handle, qty 1*

\*Available to order



NERVE CARE. EMPOWERED.

Checkpoint Surgical, Inc.  
6050 Oak Tree Blvd., Ste. 360  
Independence, OH 44131

Toll-free: 877.478.9106  
Local: 216.378.9107  
Fax: 216.378.9116  
info@checkpointsurgical.com  
checkpointsurgical.com

